



Lillian Allbon Animal Shelter
798 Smith Road
Upper Nappan, NS
B4H 3Y4

(902) 661-7297

2023 Campaign for a New Shelter



An Introduction

The Lillian Allbon Animal Shelter has been active in Cumberland County since 1987, providing a necessary service to our community. The time has come to replace our facility, and we are seeking your support to make this project a reality.

We have been operating from our current building for many years. When our current location was opened, it was not purpose-built to be an animal shelter. Not only have we outgrown the facility; the building is not efficient, and we are running into costly issues concerning ventilation, mould, and increasing operating costs and repairs.

Our organization has been very successful as an independent animal shelter. The LA Animal Shelter has earned a reputation for care and dedication in Cumberland County and beyond. Adopting out hundreds of animals every year, caring for abused and sick animals, and engaging with the community are all part of our mission.

The immediate benefit of this new building will be a reduction in operating costs. Our poorly ventilated facility has resulted in airborne illnesses spreading among the dozens of animals in our care, which is detrimental to the health of the animals and results in very high veterinary bills. The more efficient building will also reduce the cost of heating and cooling. In our final design we intend to include solar power, which will increase efficiency, reduce our carbon footprint, and provide a long-term renewable power source.

After years of patches and Band-Aids, we are excited to unveil our vision for a new facility.

We are taking on the ambitious goal of building a new shelter that will not only reap immediate benefits to our animals and staff, but also create a gathering place for families in our community to interact with animals, spend time outdoors, and volunteer their time.

We invite you to learn more about the Lillian Allbon Animal Shelter, and our project to ensure that its important service to our community continues into the next generation.

Our vision is to build a new facility worthy of the animals we protect and the community we serve.

With your help, we will make this vision a reality.



About The Lillian Allbon Animal Shelter



The LA Animal Shelter is an independent shelter that proudly follows no-kill principles and believes that all animals are deserving of a second chance and a loving home. Our shelter provides a warm, nurturing surrounding for stray, neglected, sick and surrendered dogs and cats in Cumberland County and surrounding areas.

Our mission is to rescue dogs and cats to provide them with the care they need. We operate an adoption program that finds a loving home for these animals.

Since 1987, the LA Animal Shelter has provided an essential service to families in Cumberland County. We are essential to a senior citizen who is entering a nursing home and can no longer care for their pet. We are essential to the family who has no choice but to relocate to a home that doesn't allow pets. We are essential to rescued abused cats and dogs who need a safe place to stay. Our SafePet program is essential to an abused woman who prolongs a dangerous relationship out of concern for their pet.

The shelter has also grown into a community gathering place, where volunteers and staff work together to care for the animals. On any given day, you can find retired seniors who get their exercise and social interaction by walking the dogs on our grounds. You can find high school students who earn volunteer credit at the shelter, and a large number of regular volunteers who just love to give back.

Our facility is located at 798 Smith Road, just outside of Amherst. Our property features a walking trail through the woods and ample space for staff and volunteers to interact with the animals outdoors.

Aside from the important work of rescuing and rehoming animals, we consider it part of our mission to engage with the community to advocate for animal welfare. You can learn more about these programs in this brochure, as well as our exciting plan to do even more.

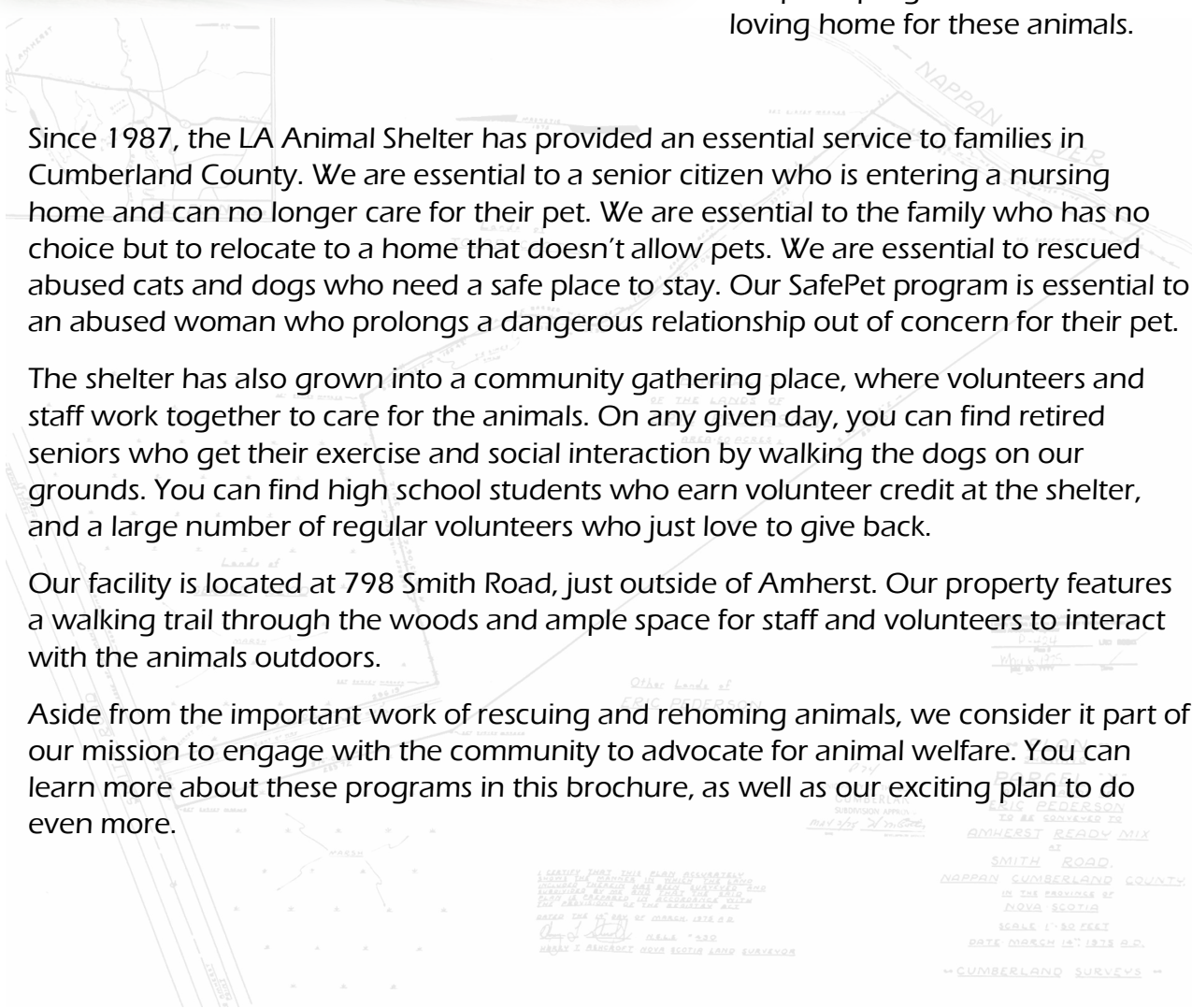

Other lands of
Lillian Allbon
Cumberland County
ANIMAL SHELTER

SMITH ROAD
NAPPAN CUMBERLAND COUNTY
IN THE PROVINCE OF
NOVA SCOTIA
SCALE 1"=50 FEET
DATE MARCH 15, 1978 A.D.
- CUMBERLAND SURVEYS -

Quick Facts

- To sustain our operation, The LA Animal Shelter relies on donations from the public, fundraising efforts, government partnerships, and adoption fees;
- In 2022 we adopted out 454 cats and dogs;
- The LA Animal Shelter is on sound financial footing, with healthy operating and capital reserves. The Shelter has allocated \$200,000 to this capital campaign, providing an amazing head start to build our new shelter!
- We currently employ two full time staff and several part-time employees. Our team is supported by dozens of volunteers from our community;
- The LA Animal Shelter's normal fundraising activities include a Spring Tea, Annual Yard Sale, raffles, calendar, and weekly online auctions;
- We operate important community programs such as our *SafePet Program*, the *Working Cat Program* and *Mama's Last Litter Program*, which we have described in more detail in the following pages.
- The shelter has been operating independently since 1987, with annual surpluses most years.

The last three years of financial results are as follows:



Why Support this Project?

The LA Animal Shelter has operated successfully from its current location for many years, despite the limitations of our old building. We are now facing the reality that the building will require substantial and ongoing upgrades in order to meet the standards required to be safe for staff and our animals.

To ensure the viability of the shelter for the next generation, we have no choice but to undertake this ambitious project to construct a new building.

The following are selected photos of our current building.

To ensure we *have* an animal shelter, we must build this new facility.



The main entrance to the LA Animal Shelter is exposed to the elements and not accessible



Furnace room and central area for laundry and animal washing stations



Poorly insulated Interior walls



Interior walls



Many of our kennels have pass-through doors which allow dogs to access the outdoors.

Unfinished concrete cuts and scrapes larger dogs, any many animals are too large to fit through the doors.

Only one kennel has a door large enough with finished concrete to allow a big dog to pass through safely.

In the winter these doors allow freezing cold air into the building, contributing to our operating costs.



Exposed plumbing is evident throughout the building, as additional facilities have been added or repaired over the years.

Our Vision for the New Shelter

The new shelter facility has been carefully designed to serve the needs of our organization for decades to come. With a focus on simplicity and efficiency, we have designed the building and grounds to provide a safe, clean and efficient space for our staff as well as the animals in our care.

The footprint of the new building is about 4,000 square feet, with about 500 square feet of outdoor kennel space under the roof.

This one storey building will be large enough to meet the needs of our shelter, without any excess that would increase the cost of the project.



This rendering shows some of the key features of our building design. The new shelter will feature a covered entrance for protection from the elements for animal intake, a small garage, and indoor/outdoor kennels for dogs.

Major improvements include upgrades that will enhance the quality of life for the animals in our care, as well as increase the efficiency of our operations. Highlights of these upgrades include:

- Facilities to properly quarantine sick animals, which will prevent the spread of disease and reduce veterinary costs;
- The facility will be accessible and safe for all volunteers and visitors;
- Accessibility will be greatly improved, so we can welcome all volunteers and visitors to the shelter;
- Hybrid indoor/outdoor living areas for the cats and dogs;
- Space for families to better interact with animals before adoption, as well as dedicated rooms for intake, veterinary care, pregnant animals, laundry facilities, and grooming.
- Kennels and stalls made with easy-to-clean materials, with proper drainage in each unit;
- Improved ventilation to improve air quality and reduce the transmission of airborne disease;
- Modest but necessary staff space for breaks, lunch and meetings;
- A welcoming outdoor space on our existing property, which provides the community an opportunity to engage with our animals, volunteer, and spend time outdoors;

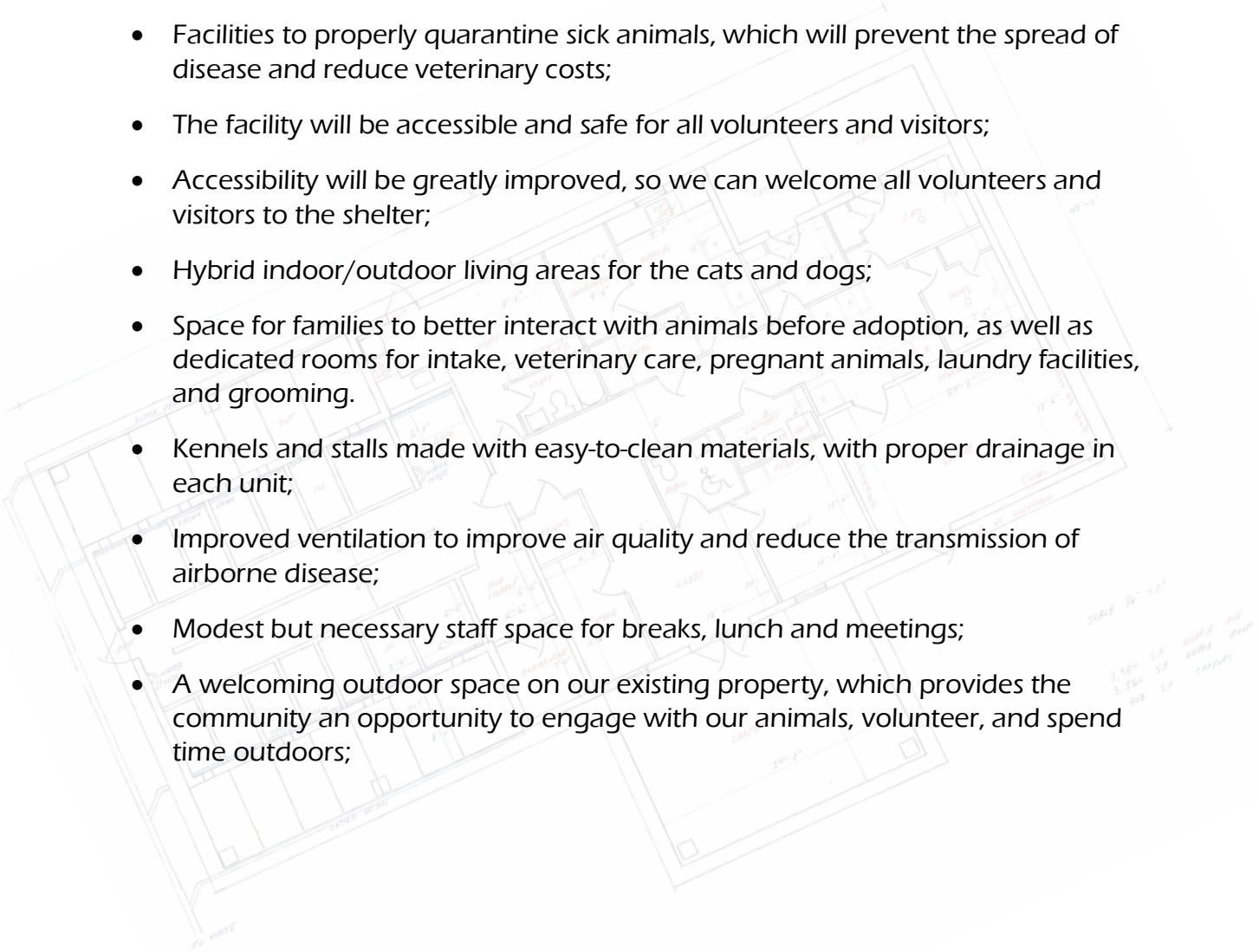

Community Engagement and Programs



The new building and grounds will welcome volunteers, families, and children to interact with animals and learn about the important work of the animal shelter.

The grounds will be a gathering place for the community, allowing members of the community to walk the trails with the animals, and children can spend time outdoors on our beautiful grounds.

We envision a space where schools can organize class trips to our new shelter, providing kids with the opportunity to interact with animals and learn the responsibility of caring for others and volunteering in their community.

Cumberland SafePet Program

The SafePet Program is a partnership between Autumn House, Amherst Veterinary Hospital, and the Lillian Allbon Animal Shelter. The program assists women who may be delaying their decision to leave an abusive partner because they cannot take their pets with them to Autumn House. Pet foster parents provide the life changing service of temporary care and shelter for the pets so the women and families at risk of abuse can stay in safety at Autumn House.



Amherst Veterinary
Hospital



Nearly 50% of women will delay leaving an abusive partner out of concern for their pets. Almost two-thirds said their partner had abused or even killed a pet.

—OSPCA 1998

Mama's Last Litter Program

Over the last decade the LA Animal Shelter has been operating our "Mama's Last Litter Program" as part of our ethical approach to reducing the number of homeless dogs and cats in our region.

Through our program, we have been committed to help reduce pet overpopulation, prevent unplanned litters, and ensure every animal has a home in our local and surrounding communities.

This program has been particularly beneficial to Cumberland County families who encounter financial challenges, and are unable to pay their pets.



Working Cat Program

The LA Animal Shelter take in cats and kittens from all walks of life. Most are great adoption candidates, and we are able to find fantastic homes for them. However, there are cats who come through our doors who are feral or semi-feral. They are not adoptable as loving house cats and can't be released due to food insecurities and lack of housing. These cats enter our working cat program!



The cats are spayed or neutered, and vetted so they will not contribute to overpopulation. These cats will never be cuddly, loving house pets but the working cats program gives these cats a chance to live life the best way they can with consistent food, shelter and water. Every barn needs a cat or two on duty!

With this program we find homes for all our cats who otherwise wouldn't have a safe place to call home.

Cost and Funding:

The construction of the facility will be a testament to the generosity of our community. The cost of the project will be approximately \$1.1 million.

We need donations and capital commitments to complete this important project. We have very successfully operated the shelter independently for decades. We have strong operational cash flow from our adoption program and regular fundraising. The shelter has posted annual surpluses for many years, and the new facility will only decrease the shelter's operating costs.

At the launch of this capital campaign, we are excited to report the following:

- The LA Animal Shelter has allocated \$200,000 from previous fundraising efforts to be the seed money for this capital campaign.
- We are pursuing a number of grants and government programs.
- Our fundraising team is planning a number of large fundraising activities to engage the community and seek private donations.
- We have secured a number of in-kind commitments to assist with the cost of materials in the construction of the building.

Most importantly, we are seeking leadership donations from people like you to make our vision a reality.